

51

FIXED ROUTE

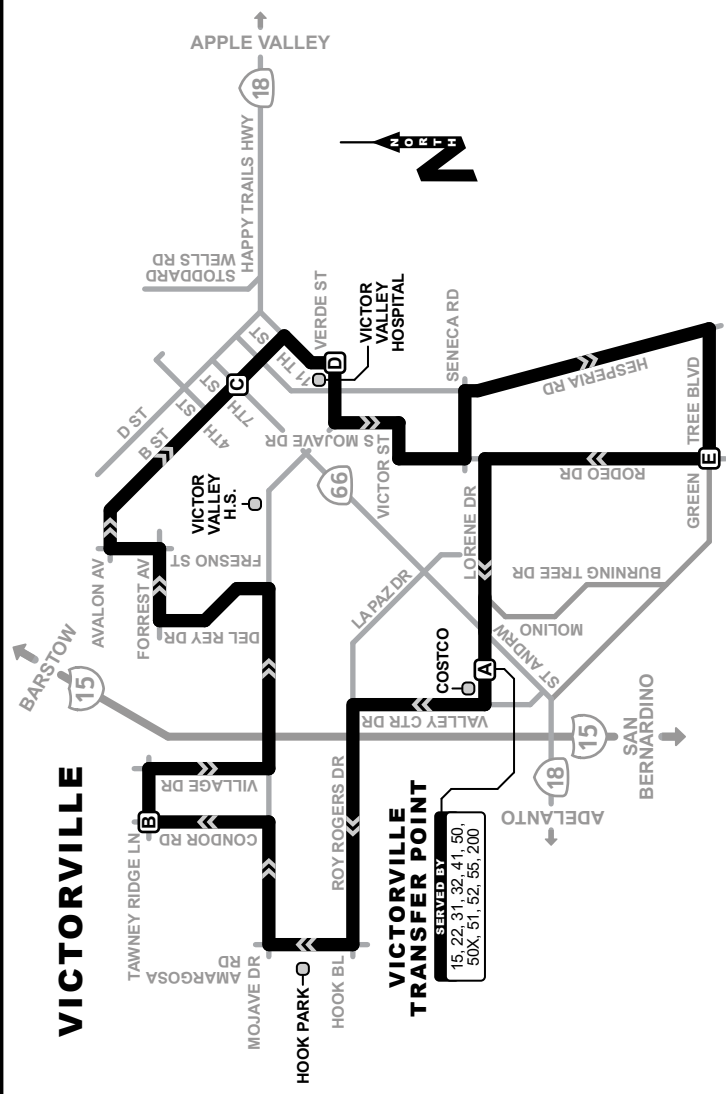

SERVED BY
15, 22, 31, 32, 41, 50,
50X, 51, 52, 55, 200.

VICTORVILLE TRANSFER POINT, COSTCO, VICTOR VALLEY H.S., VICTOR VALLEY HOSPITAL

VICTORVILLE CIRCULATOR		VICTORVILLE CIRCULATOR	
▶ NORTH		▶ SOUTH	
#	STO	#	STO
(A) 50007	Victorville Transfer Pt Lorene / 7th	(D) 50079	Victor Valley Hospital 11th St / Verde St
(B) 50146	Condor Road Tawney Ridge	(D) 50079	Victor Valley Hospital 11th St / Verde St
(C) 50114	B St 7th St	(E) 50192	Green Tree Bl Rodeo Dr
		(A) 50007	Victorville Transfer Pt Lorene / 7th
DEPART	ARRIVE	DEPART	ARRIVE
6:00	6:20	6:25	6:30
7:00	7:10	7:25	7:30
8:00	8:10	8:25	8:30
9:00	9:10	9:25	9:30
10:00	10:10	10:25	10:30
11:00	11:10	11:25	11:30
12:00	12:10	12:25	12:30
1:00	1:10	1:25	1:30
2:00	2:10	2:25	2:30
3:00	3:10	3:25	3:30
4:00	4:10	4:25	4:30
5:00	5:10	5:25	5:30
6:00	6:10	6:25	6:30
7:00	7:10	7:25	7:30
8:00	8:10	8:25	8:30
WEEKDAY			
7:00	7:20	7:25	7:30
8:00	8:20	8:25	8:30
9:00	9:20	9:25	9:30
10:00	10:20	10:25	10:30
11:00	11:20	11:25	11:30
12:00	12:20	12:25	12:30
1:00	1:20	1:25	1:30
2:00	2:20	2:25	2:30
3:00	3:20	3:25	3:30
4:00	4:20	4:25	4:30
5:00	5:20	5:25	5:30
6:00	6:20	6:25	6:30
7:00	7:20	7:25	7:30
8:00	8:20	8:25	8:30
7:00	7:20	7:25	7:30
8:00	8:20	8:25	8:30
9:00	9:20	9:25	9:30
10:00	10:20	10:25	10:30
11:00	11:20	11:25	11:30
12:00	12:20	12:25	12:30
1:00	1:20	1:25	1:30
2:00	2:20	2:25	2:30
3:00	3:20	3:25	3:30
4:00	4:20	4:25	4:30
5:00	5:20	5:25	5:30
6:00	6:20	6:25	6:30
7:00	7:20	7:25	7:30
8:00	8:20	8:25	8:30
7:00	7:20	7:25	7:30
8:00	8:20	8:25	8:30
9:00	9:20	9:25	9:30
10:00	10:20	10:25	10:30
11:00	11:20	11:25	11:30
12:00	12:20	12:25	12:30
1:00	1:20	1:25	1:30
2:00	2:20	2:25	2:30
3:00	3:20	3:25	3:30
4:00	4:20	4:25	4:30
5:00	5:20	5:25	5:30
6:00	6:20	6:25	6:30
7:00	7:20	7:25	7:30
8:00	8:20	8:25	8:30

VICTORVILLE CIRCULATOR		VICTORVILLE CIRCULATOR	
▶ NORTH		▶ SOUTH	
#	STO	#	STO
(A) 50007	Victorville Transfer Pt Lorene / 7th	(D) 50079	Victor Valley Hospital 11th St / Verde St
(B) 50146	Condor Road Tawney Ridge	(D) 50079	Victor Valley Hospital 11th St / Verde St
(C) 50114	B St 7th St	(E) 50192	Green Tree Bl Rodeo Dr
		(A) 50007	Victorville Transfer Pt Lorene / 7th
DEPART	ARRIVE	DEPART	ARRIVE
6:00	6:20	6:25	6:30
7:00	7:10	7:25	7:30
8:00	8:10	8:25	8:30
9:00	9:10	9:25	9:30
10:00	10:10	10:25	10:30
11:00	11:10	11:25	11:30
12:00	12:10	12:25	12:30
1:00	1:10	1:25	1:30
2:00	2:10	2:25	2:30
3:00	3:10	3:25	3:30
4:00	4:10	4:25	4:30
5:00	5:10	5:25	5:30
6:00	6:10	6:25	6:30
7:00	7:10	7:25	7:30
8:00	8:10	8:25	8:30
7:00	7:20	7:25	7:30
8:00	8:20	8:25	8:30
9:00	9:20	9:25	9:30
10:00	10:20	10:25	10:30
11:00	11:20	11:25	11:30
12:00	12:20	12:25	12:30
1:00	1:20	1:25	1:30
2:00	2:20	2:25	2:30
3:00	3:20	3:25	3:30
4:00	4:20	4:25	4:30
5:00	5:20	5:25	5:30
6:00	6:20	6:25	6:30
7:00	7:20	7:25	7:30
8:00	8:20	8:25	8:30
7:00	7:20	7:25	7:30
8:00	8:20	8:25	8:30
9:00	9:20	9:25	9:30
10:00	10:20	10:25	10:30
11:00	11:20	11:25	11:30
12:00	12:20	12:25	12:30
1:00	1:20	1:25	1:30
2:00	2:20	2:25	2:30
3:00	3:20	3:25	3:30
4:00	4:20	4:25	4:30
5:00	5:20	5:25	5:30
6:00	6:20	6:25	6:30
7:00	7:20	7:25	7:30
8:00	8:20	8:25	8:30

VICTORVILLE CIRCULATOR		VICTORVILLE CIRCULATOR	
▶ NORTH		▶ SOUTH	
#	STO	#	STO
(A) 50007	Victorville Transfer Pt Lorene / 7th	(D) 50079	Victor Valley Hospital 11th St / Verde St
(B) 50146	Condor Road Tawney Ridge	(D) 50079	Victor Valley Hospital 11th St / Verde St
(C) 50114	B St 7th St	(E) 50192	Green Tree Bl Rodeo Dr
		(A) 50007	Victorville Transfer Pt Lorene / 7th
DEPART	ARRIVE	DEPART	ARRIVE
6:00	6:20	6:25	6:30
7:00	7:10	7:25	7:30
8:00	8:10	8:25	8:30
9:00	9:10	9:25	9:30
10:00	10:10	10:25	10:30
11:00	11:10	11:25	11:30
12:00	12:10	12:25	12:30
1:00	1:10	1:25	1:30
2:00	2:10	2:25	2:30
3:00	3:10	3:25	3:30
4:00	4:10	4:25	4:30
5:00	5:10	5:25	5:30
6:00	6:10	6:25	6:30
7:00	7:10	7:25	7:30
8:00	8:10	8:25	8:30
7:00	7:20	7:25	7:30
8:00	8:20	8:25	8:30
9:00	9:20	9:25	9:30
10:00	10:20	10:25	10:30
11:00	11:20	11:25	11:30
12:00	12:20	12:25	12:30
1:00	1:20	1:25	1:30
2:00	2:20	2:25	2:30
3:00	3:20	3:25	3:30
4:00	4:20	4:25	4:30
5:00	5:20	5:25	5:30
6:00	6:20	6:25	6:30
7:00	7:20	7:25	7:30
8:00	8:20	8:25	8:30

GET ALERTS: EMAIL MyAlerts@VVTA.org | TEXT "VVTA" to 38470 | TWITTER @VVTransit

51

FIXED ROUTE

VICTORVILLE CIRCULATOR

Victorville Transfer Point, Costco, Victor Valley H.S., Victor Valley Hospital, Green Tree Blvd.

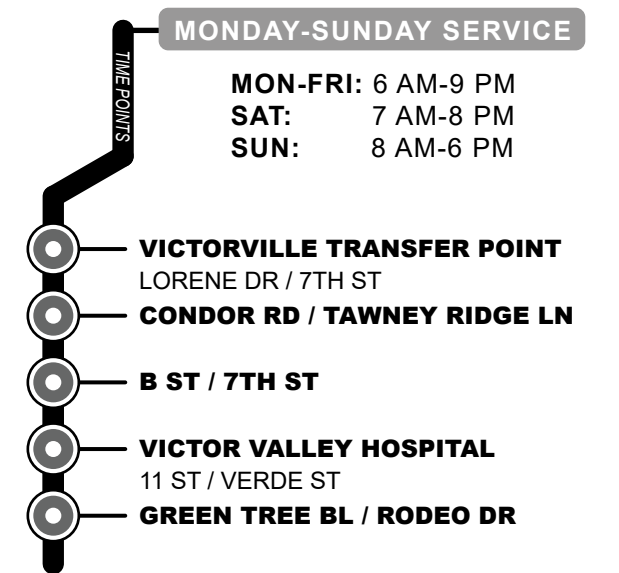

VICTOR VALLEY TRANSIT

REVISED: MARCH 1, 2019

760-948-3030 VVTA.ORG